



## 125MHz 1310nm/1550nm InGaAs PIN plus AGC Pre-Amplifier Photodiode in TO-46 Package, 5-pin

Part No. PDT-A13P5-1MB4

### Features

- 1310nm/1550nm InGaAs PINTIA 5 pin TO
- Industry standard TO-46 package with short cap lens and tab-less
- Optimized for fiber optic application
- Suitable for 100/155 Mbps applications
- Photocurrent monitoring available
- Supports 3.3V to 5.0V applications



### Specifications

Electro-Optical Characteristics (Typical values are at $V_{CC}=3.3V$ at $25^{\circ}C$ )						
Parameters	Symbol	Min.	Typ.	Max.	Unit	Conditions
Power Supply	$V_{CC}$	3.0		5.5	V	
Supply Current	$I_{CC}$			35	mA	No loads
Differential Responsivity	$R_d$	0.10		120	mV/uW	$\lambda=1310nm, R_{load}=100ohm$
Single Ended Responsivity	$R_s$	0.05		60	mV/uW	$\lambda=1310nm, R_{load}=50ohm$
Small-Signal Bandwidth	BF	115			MHz	$\lambda=1310nm, P=-20dBm$
Rise/Fall Time (20-80%)	tr/tf			4.5	ns	$\lambda=1310nm, P=-20dBm$
Saturation Power	$P_{sat}$	0			dBm	
Single Ended Output Impedance	$R_O$		50		ohm	
Wavelength	$\lambda$	1260		1620	nm	
Sensitivity				-36	dBm	$\lambda=1310nm, @155.52Mbps, PRBS23, BER=10^{-10}$

Absolute Maximum Ratings					
Parameters	Min.	Max.	Unit	Conditions	
Storage Temperature	-40	100	$^{\circ}C$		
Operating Temperature	-40	85	$^{\circ}C$		
Lead Solder Temperature		260	$^{\circ}C$	10 seconds	

### Outline Dimensions (unit: mm)

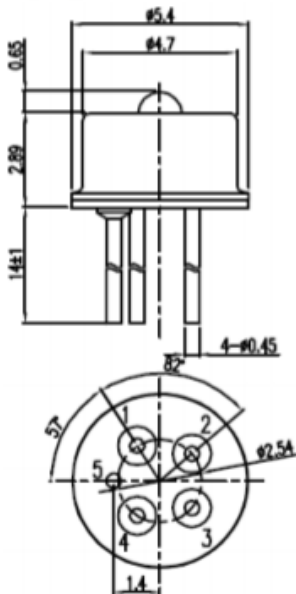

#### Pinout:

1. Dout
2. Vcc
3.  $V_{pd}$
4. Dout
5. Gnd

Note: Specifications are subject to change without notice.

**Lasermate Group, Inc.**

19608 Camino De Rosa, Walnut, CA 91789, USA

Tel: (909)718-0999 | Fax: (909)718-0998 | E-mail: [info@lasermate.com](mailto:info@lasermate.com) | URL: <http://www.lasermate.com>