



Light Source Optical Testing Tool

Technical Specifications and Operating Instructions



Description

The Light Source is a handy instrument that provides several wavelengths for testing the fiber equipment in an optical network and FTTx construction. Light Source is ideal for field or laboratory testing of optical communication systems at 850nm / 1300nm for datacom testing, 1310nm / 1550nm / CWDM 1270nm ~ 1610nm (20nm spans) for all WDM testing, as well as 1490 nm for FTTx testing by changing the interchangeable SFP module. Light Source features zero warm up, superb productivity and is easy to use with its pocket-size and rugged handy design.

With a LC / SC patch cord, the Light Source can be used for most widespread fiber interfaces such as LC / ST / SC / FC connectors. It is suitable to test both Singlemode and Multimode cables.

Internally there is a specially designed power circuit called APC (Auto Power Control). The APC circuit provides continuous power which avoids unstable laser output when the battery is low.

The LD output signal can be switched between Continuous Wave (CW) or Pulse Mode 270Hz / 2KHz Modulated Mode to simulate signal transmission. There is a dust proof cap which will prevent dirt from getting into the LD connector. The cap also helps avoid accidental exposure to the laser beam into your eyes.

Features

- Pocket-size & rugged, handy design
- No warm-up time required
- Interchangeable SFP Module design with LC or SC connector
- Flexible for changing wavelengths
- High Output Power stability
- Stable output wavelength
- Excellent re-connection repeatability
- LED indicators for Low Voltage Battery warning signal
- Economical and easy to use
- Operates in CW (Continuous Wave) or Pulse Mode 270Hz / 2KHz
- Dust-proof design keeping fiber connectors clean
- Operates on two AAA-size alkaline batteries

Applications

- Maintenance CATV / Telecom / FTTH in Single mode or Multimode fiber optical fiber networks
- Testing in standard laboratories
- High throughput quality assurance

Lasermate Group, Inc.

19608 Camino De Rosa, Walnut, CA 91789, USA

Tel: (909)718-0999 | Fax: (909)718-0998 | E-mail: info@lasermate.com | URL: <http://www.lasermate.com>

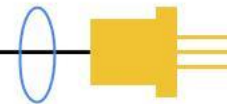

Specifications

Laser Class	Class 1
Wavelength (nm)	850, 1300, 1310, 1550 1270, 1290, 1310, 1330, 1350, 1370, 1390, 1410, 1430, 1450, 1470, 1490, 1510, 1530, 1550, 1570, 1590, 1610, 1625, 1650
Mode	CW / Pulse Mode 270 Hz / 2 KHz
Batteries	AAA 1.5V X 2
LED Indicator	Power On (GREEN) / Battery Low (RED)
Output Power Accuracy	+/- 0.2 dB
Output Power Stability (1 HR)	+/- 0.2 dB
Operating Temperature	0°C ~ 50°C
Storage Temperature	0°C ~ 70°C

S200126X0850	Min.	Typ.	Max.	Unit	Note
VCSEL Output Power	-5		+5	dBm	@ 25°C 62.5 / 125 μm fiber
Center Wavelength λ _c		850		nm	@ 25°C 62.5 / 125 μm fiber
Spectral Width Δλ			0.85	nm	@ 25°C 62.5 / 125 μm fiber

S200122X1300	Min.	Typ.	Max.	Unit	Note
LED Output Power	-22		-10	dBm	@ 25°C 62.5 / 125 μm fiber
Center Wavelength λ _c	1270	1310	1370	nm	@ 25°C 62.5 / 125 μm fiber
Spectral Width Δλ (FWHM)			180	nm	@ 25°C 62.5 / 125 μm fiber

S200123X1310	Min.	Typ.	Max.	Unit	Note
FP LD Output Power	-5		+5	dBm	@ 25°C 9 / 125 μm fiber
Center Wavelength λ _c	1290	1310	1330	nm	@ 25°C 9 / 125 μm fiber
Spectral Width Δλ			4	nm	@ 25°C 9 / 125 μm fiber

S200123X1550	Min.	Typ.	Max.	Unit	Note
FP LD Output Power	-5		+5	dBm	@ 25°C 9 / 125 μm fiber
Center Wavelength λ _c	1520	1550	1570	nm	@ 25°C 9 / 125 μm fiber
Spectral Width Δλ			4	nm	@ 25°C 9 / 125 μm fiber

S200124X1310	Min.	Typ.	Max.	Unit	Note
DFB LD Output Power	-3		+5	dBm	@ 25°C 9 / 125 μm fiber
Center Wavelength λ _c	1290	1310	1330	nm	@ 25°C 9 / 125 μm fiber
Spectral Width Δλ			1	nm	@ 25°C 9 / 125 μm fiber
Side-mode Suppression Rate	30			dB	@ 25°C 9 / 125 μm fiber

S200124X1550	Min.	Typ.	Max.	Unit	Note
DFB LD Output Power	-3		+5	dBm	@ 25°C 9 / 125 μm fiber
Center Wavelength λ _c	1530	1550	1570	nm	@ 25°C 9 / 125 μm fiber
Spectral Width Δλ			1	nm	@ 25°C 9 / 125 μm fiber
Side-mode Suppression Rate	30			dB	@ 25°C 9 / 125 μm fiber

S200124X1625	Min.	Typ.	Max.	Unit	Note
DFB LD Output Power	-3		+5	dBm	@ 25°C 9 / 125 μm fiber
Center Wavelength λ _c	1620	1625	1630	nm	@ 25°C 9 / 125 μm fiber
Spectral Width Δλ			1	nm	@ 25°C 9 / 125 μm fiber
Side-mode Suppression Rate	30			dB	@ 25°C 9 / 125 μm fiber

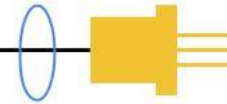

S200124X1650	Min.	Typ.	Max.	Unit	Note
DFB LD Output Power	-3		+5	dBm	@ 25°C 9 / 125 μm fiber
Center Wavelength λ _c	1645	1650	1655	nm	@ 25°C 9 / 125 μm fiber
Spectral Width Δλ			1	nm	@ 25°C 9 / 125 μm fiber
Side-mode Suppression Rate	30			dB	@ 25°C 9 / 125 μm fiber

S200125Xxxxx	Min.	Typ.	Max.	Unit	Note
CWDM LD Output Power	-3		+5	dBm	@ 25°C 9 / 125 μm fiber
Center Wavelength λ _c	λ _c *- 3	λ _c *	λ _c *+3	nm	@ 25°C 9 / 125 μm fiber
Spectral Width Δλ			1	nm	@ 25°C 9 / 125 μm fiber
Side-mode Suppression Rate	30			dB	@ 25°C 9 / 125 μm fiber

X=0, LC Connector

X=1, SC Connector

*CWDM LD λ_c: S200125Xxxxx

1270 nm / 1290 nm / 1310 nm / 1330 nm / 1350 nm / 1370 nm / 1390 nm / 1410 nm / 1430 nm / 1450 nm / 1470 nm / 1490 nm / 1510 nm / 1530 nm / 1550 nm / 1570 nm / 1590 nm / 1610 nm

Operating Instructions

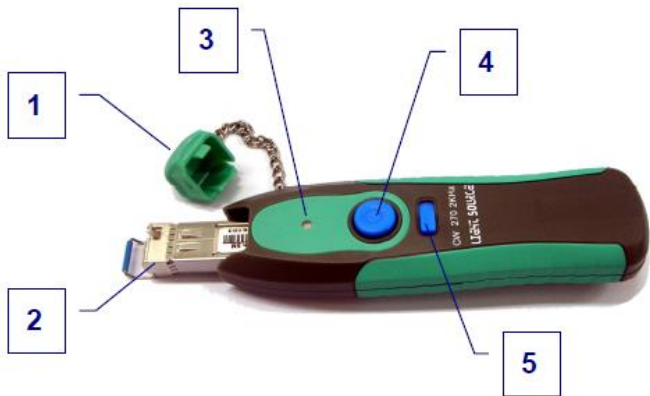

- 1) Dust Cap: prevent dirt contaminating the LD connector.
- 2) SFP Module: Interchangeable single LC or SC connector; hot swap SFP module for identical wavelength.
- 3) LED Indicator: Power On and In Operation indicator (GREEN) and Battery Low Warning indicator (RED).
- 4) Button: pressing to Turn On / Turn Off LD emitting.
- 5) Mode Switch: to select (CW) Continuous Wave Mode / Pulse Mode 270 Hz / 2 KHz Switch.
- 6) Pen Clip: to fasten the tool while inside your pocket.
- 7) Battery Lid: open to change batteries.
- 8) Linchpin: a mechanical design to lock the battery lid.

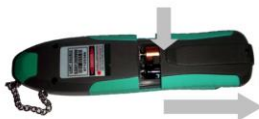

To press to release Linchpin then to push battery lid backward.



To open battery lid to change batteries.

1. The Light Source is powered by two 1.5 V AAA batteries.
2. Insert Plug-In Module into the Light Source Main Frame, press Button and check if the LED is GREEN.
3. Press button to turn off Light Source.
4. Lift the front of the dust cap and directly insert into a connector of the fiber LC or SC patch cord.
5. Switch to select to Continuous Wave (CW) Mode or Pulse Mode 270 Hz/ 2 KHz.
6. Press the button to turn on the Light Source. The LED Indicator now is GREEN while the Light Source is in operation.
7. Press the button a second time to turn off the Light Source. The LED Indicator will be turned off.
8. When the LED Indicator is RED, this means the batteries are almost depleted and in low voltage status. You must replace the batteries immediately for proper operation.
9. Do not touch the Light Source connector to avoid placing dirt into the connector.
10. Keep the dust cap on while the Light Source is not in use.
11. Use the proper cleaning tools to clean the Light Source SFP connector before testing in order to obtain best results and to keep the Light Source in service longer.

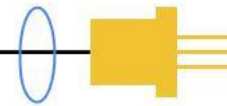

Maintenance

This tool requires no maintenance other than periodic battery changes. Like any piece of electronic equipment, this tool should be kept away from water, high dampness, dust, electricity, and environments of extreme temperature. Do not drop this tool on a hard surface. Modifying any of this tool's internal components can cause a malfunction and will invalidate the manufacturer's warranty.

Warranty

The manufacturer warrants this product to be free of defects in workmanship and materials for a period of 10 months after purchase. This warranty (excluding batteries) is solely limited to the repair and replacement of original parts, which are defective in workmanship or materials. All other costs are the sole responsibility of the owner. This warranty does not cover any defects, damage, or deterioration due to misuse, alteration, or negligence.

Ordering Information

Part Number	Description
S20012009999	Light Source Main Frame
S200126X0850	VCSEL 850 nm plug-in module
S200122X1300	LED 1300 nm plug-in module
S200123X1310	FP LD 1310 nm plug-in module
S200123X1550	FP LD 1550 nm plug-in module
S200124X1310	DFB LD 1310 nm plug-in module
S200124X1550	DFB LD 1550 nm plug-in module
S200124X1625	DFB LD 1625 nm plug-in module
S200124X1650	DFB LD 1650 nm plug-in module
S200125Xxxxx	CWDM LD λ_c plug-in module
X=0, LC Connector X=1, SC Connector *CWDM LD λ_c : xxxx 1270 nm / 1290 nm / 1310 nm / 1330 nm / 1350 nm / 1370 nm / 1390 nm / 1410 nm / 1430 nm / 1450 nm / 1470 nm / 1490 nm / 1510 nm / 1530 nm / 1550 nm / 1570 nm / 1590 nm / 1610 nm	

**To perform the light source test, you will need to order one main frame (part number S20012009999) and at least one source, i.e., 1310nm FP laser with LC connector (part number S20012301310).

Note: Specifications are subject to change without notice.